

KING CROSS LIMONE LIMONE SUL GARDA



Limone del Garda is a tourist resort mainly visited by foreigners from March to the end of October. This small, but important Shopping Centre was built in relation to this aspect.

Data:	
Total Area:	5.535 m ²
Indoor Area:	3.700 m ²
GLA Hypermarket:	506 m ²
GLA Gallery:	1.700 m ²
Shops:	11
Parking spaces:	500
Mid-size units:	1



Location:
The Shopping Centre is connected with the town centre by an easy pedestrian route. The access to its car park is directly from the coastal road, called "Gardesana Occidentale".

KING CROSS NOAL LUMEZZANE



The Shopping Centre was built within a plan of urban upgrading. Besides the retail area, the building contains offices and apartments and an underground three-storey car park.

Data:	
Total Area:	5.390 m ²
Indoor Area:	3.750 m ²
GLA Hypermarket:	1.620 m ²
GLA Gallery:	4.822 m ²
Shops:	32
Parking spaces:	324
Mid-size units:	3



Location:
Noal is placed in the heart of the urban centre and it is close to the main street of the town.



Level 0

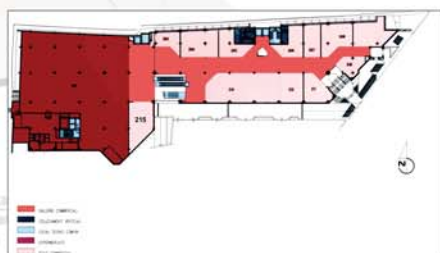

Level 1



Level 2